

# KING PINS & BLOCKS

KING PINS

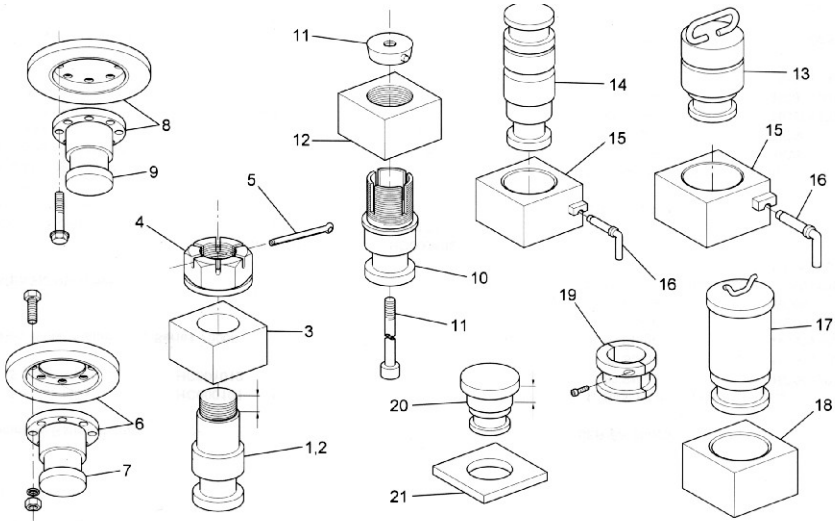

1. <b>Std 50mm Bolt in King Pin</b> Thread length 48mm Thread length 33mm	For 10 & 12mm Rubbing plate	14. <b>Drop in Double Ended -</b> 50mm & 90mm King Pin
2. <b>90mm King Pin to suit</b> 500mm block - NB: Temporary use only	7. <b>50mm King Pin item 6</b>	15. <b>King Pin Block -</b> For items 13 & 14 above
3. <b>Std 50mm King Pin Block -</b> For item 1 & 2 6mm thk Rubbing plate 8mm thk Rubbing plate 10mm thk Rubbing plate	8. <b>50mm King Pin</b> Underside Renewable - Complete assembly - For 8mm Rubbing plate For 10mm Rubbing plate	16. <b>Locking Pin for King Pin Block -</b> For item 15 above
4. <b>Std King Pin Nut for</b> Item 1 & 2 above - for 48mm thread length for 33mm thread length	9. <b>50mm King Pin for Item 8</b>	17. <b>Drop in King Pin c/w</b> Handle - 50mm King Pin 90mm King Pin
5. <b>Split pin</b> 8 x 140	10. <b>50mm King Pin</b> underside renewable - Complete assembly - items 10 & 11 King Pin only item 10	18. <b>King Pin Block -</b> For items 17 above
6. <b>50mm King Pin</b> Underside renewable - Complete assembly - For 6 & 8mm Rubbing plate	11. <b>Taper lock &amp; bolt</b>	19. <b>Conversion Split Collar -</b> 50mm to 90mm c/w Socket hd capscrews
	12. <b>50mm King Pin Block -</b> For item 10 above	20. <b>90mm King for Dolly -</b> Shank length 35mm Shank length 37mm
	13. <b>Drop in King Pin c/w</b> <b>handle -</b> 50mm King Pin 90mm King Pin	21. <b>90mm King Pin Plate -</b> For item 22 above